

EMIT-55-TRIO

Date: November 18, 2024 11:15 AM

Specifications

Voltage:	12/24V DC	Classification:	Class III	Dimmable:	No
Power:	2.5W	Beam Angle:	19° - 36° - 60°	Operating Temp:	-20°C~40°C
IP Rating:	IP67	CCT:	3000K-4000K-5500K	Cutout:	Ø43MM Without Cannister Ø48MM With Cannister

Requires 12 or 24V DC LED Constant Voltage Driver

Steps to remove the cover to adjust the colour temperature

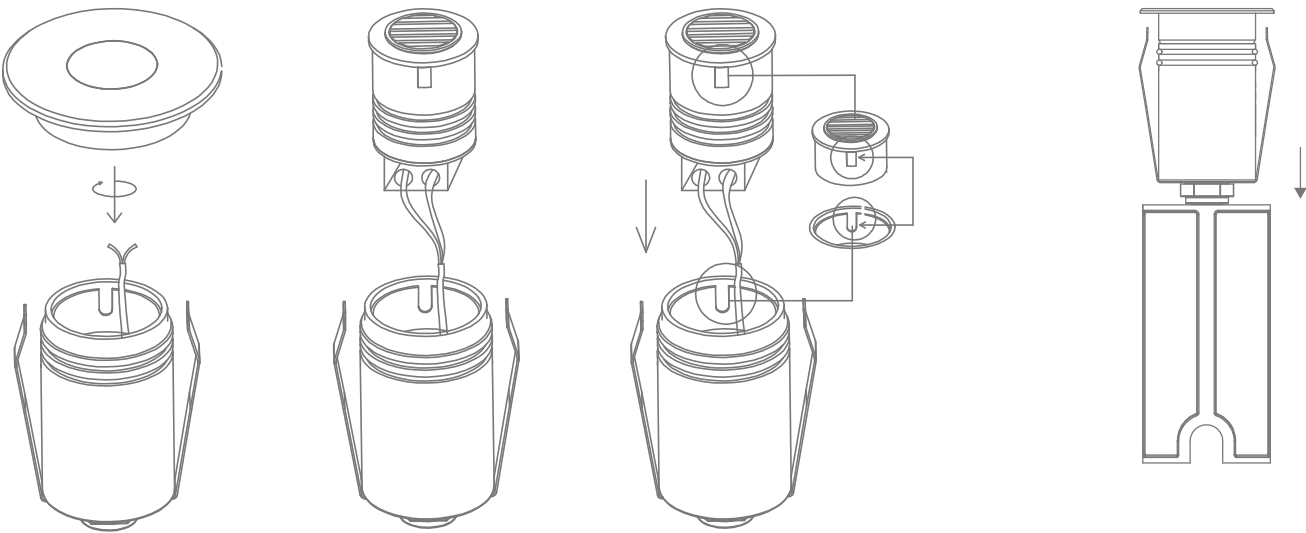

Multi CCT

Use the dip switch located at the back of the LED module to choose the desired colour temperature.

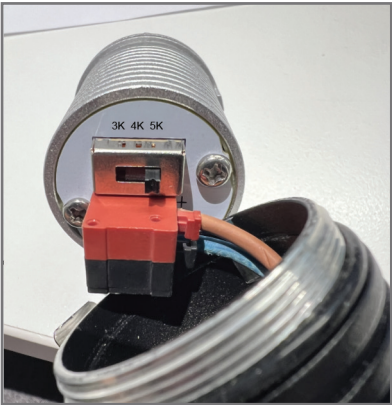

Installation with cannister

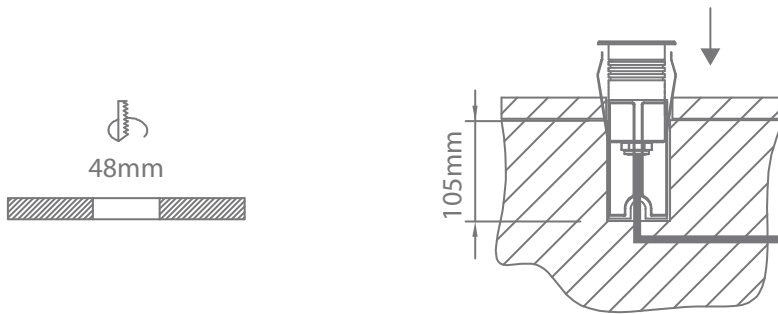

Instructions

1. This LED luminaire must be connected to a constant voltage of 12/24V DC.
WARNING! Incorrect connection may damage the luminaire.
2. Note the prescribed dimensions before assembly.
3. The light from an LED luminaire is strong, avoid looking directly into the light source.
4. Connect the LED luminaire to the converter before the converter is connected to the power source.

Installation without cannister

